

## AT-52H - Level Control

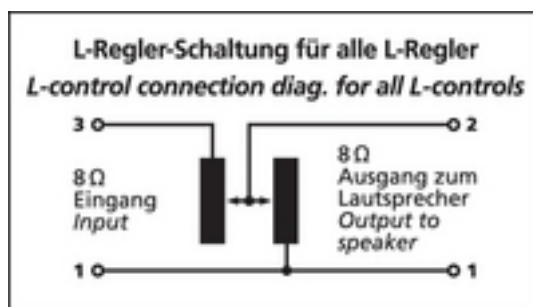
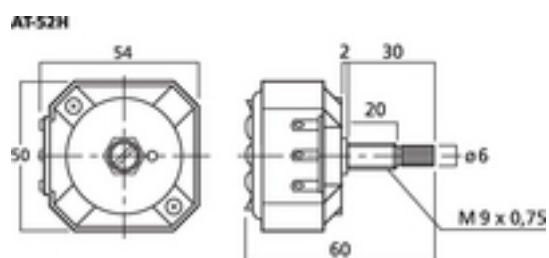

### L-pad attenuator

- Level control for speakers of medium power capability
- Mono version
- With push-on knob

## Tekniset tiedot:

Impedance	: 8 $\Omega$ Ohm $\pm$ 20%
Line input	: -
Input control voltage	: -
Line output	: -
Output control voltage	: -
Channels	: mono
Attenuation	: 0 dB to ? dB
Attenuation direction	: counterclockwise
Turning angle	: 300° $\pm$ 5°
Frequency range	: -
THD	: -
S/N ratio	: -
Power rating	: 50 W
Power supply	: -
Admiss. ambient temp.	: 0-40 °C
Dimensions	: see drawing
Weight	: 89 g
Connections	: -