

## DRIVE-08A - PA DSP Loudspeaker

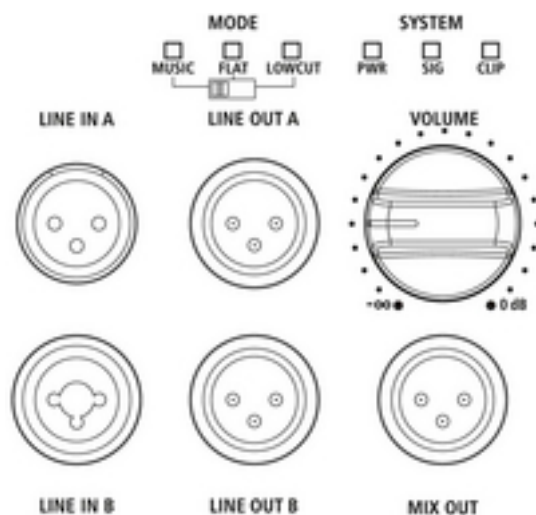
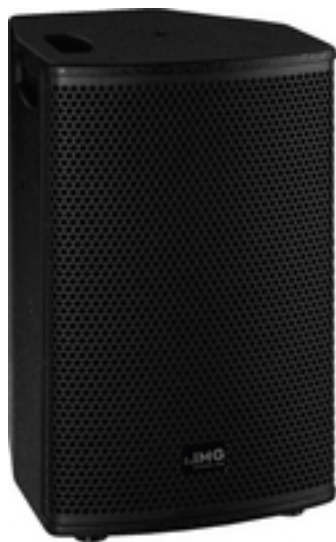

With the DRIVE series

you will get robust and easy-to-use PA speakers which are suitable for versatile applications and feature the latest DSP-controlled amplifier technology. There are 3 selectable presets available to provide a perfect sound adjustment for any kind of application. These robust and high-quality cabinets made of birch plywood are suitable for general use. The arrangement of the handles allow for easy manageability.

Professional active DSP speaker system with 2-channel amplifier, 200 W

- Compact 8/2 full range system with cabinet made of birch plywood

- DSP-controlled 2-channel amplifier (bass: class D, tweeter: class A/B)
- 3 selectable presets
- FLAT (linear adjustment)
- MUSIC (slightly raised bass and treble)
- LOW CUT (with high-pass filter for application with an additional subwoofer)
- 20 cm (8") bass speaker and 25 mm (1") horn tweeter, can be turned by 90°
- Excellent sound characteristics
- High-quality coating and neat workmanship
- Multi-purpose positioning and installation options
- Horn tweeter with consistent radiation pattern
- M8 threaded inserts for suspended installation, stand sleeve
- Volume control
- 2 x balanced line in
- 2 x parallel line out
- 1 x balanced mix out
- Power and clip indicator

## Tekniset tiedot:

Active/passive	: active
Transmission technology	: cable
Total output power	: 400 W
Power rating (RMS)	: DSP-controlled 200 W (140 + 60) bass: 140 W treble: 60 W
Total power rating	: -
Power rating (RMS)	: -
Impedance	: -
Frequency range	: 60-20,000 Hz
THD	: -
S/N ratio	: -
Input signal	: 790 mV/40 kOhm (line, bal.)
System	: 8/2 full range
Full range speaker	: -
Bass speaker	: 20 cm (8") bass speaker
Midrange speaker	: -
Tweeter	: 25 mm (1") horn tweeter
Number of speakers	: 2
Speaker size	: 20 cm (8")
SPL	: 98 dB/W/m
Max. rated SPL	: 122 dB
Beam angle	: H: 90°/V: 60°, horn can be turned
Radiation angle, horizontal	: 90°
Radiation angle, vertical	: 60°
Features	: -
Housing material	: birch plywood
Colour	: black
Mounting device	: M8 threaded inserts, stand sleeve
Protected against ball rebound	: -
Protection class	: -
Admiss. ambient temp.	: 0-40 °C
Power supply	: &acd; 230Â V/50Â Hz/250 VA
Dimensions	: 270 x 460 x 290Â mm
Width	: 270 mm
Height	: 460 mm
Depth	: 290 mm

Weight	: 9.4 kg
Inputs	: 1 x comb. XLR/6.3 mm: line 1 x XLR: line
Outputs	: 2 x XLR par. out 1 x XLR mix out
Replacement voice coil	: -
Other features	: DSP-controlled limiter 3 selectable presets
Accessories	: -
Packing dimensions (W x H x L)	: 0.38 x 0.54 x 0.36 m
Gross weight	: 12.24 kg
Net weight	: 9.4 kg