

# MS-131/RT - Push Switch/Open

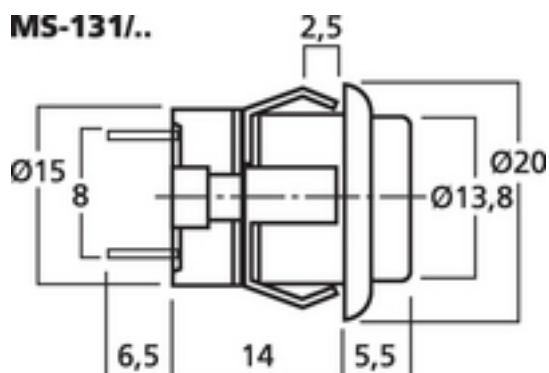

**MS-131/..**



Momentary push-buttons

- Single-pole
- NO contact
- For safety extra-low voltage or signal voltage
- Press-in mounting
- Red (RT) or black (SW)

## Tekniset tiedot:

Description	: push-button
Type	: press-in mounting
Wafers	: -
Contacts	: -
Switching function	: -
Switch positions	: -
Power rating	: -
PC spacing	: -
Colour/colour coding	: red
Mounting hole	: -
Mounting depth	: -
Dimensions	: see drawing
Weight	: 5 g